



# SUB-COMPACT V2 MINI RAIL LASER SYSTEM

## FSR-00V2-140

Introducing LaserLyte's smallest and most versatile railed laser! The V2 weighs less than an ounce and features an integrated cross lock bar, hinge clamp system and removable rail to add flashlights or other accessories.

- Fits all subcompact weapons
- Fits all railed weapons
- Push button activation
- 500-yard range at night
- Next Generation Glass Lens System
- Adjustments for windage and elevation
- Exclusive FSL Technology
- Made from T6 aluminum
- 650nm laser module
- Full 5mw of power
- One Year Limited Warranty



Removable Rail Mount Included - add Flashlight (not included) or other Accessories.

### PARTS INCLUDED



V2 laser



Picatinny Rail Mount



3 Batteries



Mounting Screws



2 Hex Wrenches

**DANGER**



LASER LIGHT  
AVOID DIRECT EYE EXPOSURE  
POWER OUTPUT <5mw  
WAVELENGTH 630-670nm  
CLASS IIIa PRODUCT

RoHS



6 89706 20968 1

FSR-00V2-140

# SUB-COMPACT V2 MINI RAIL LASER SYSTEM

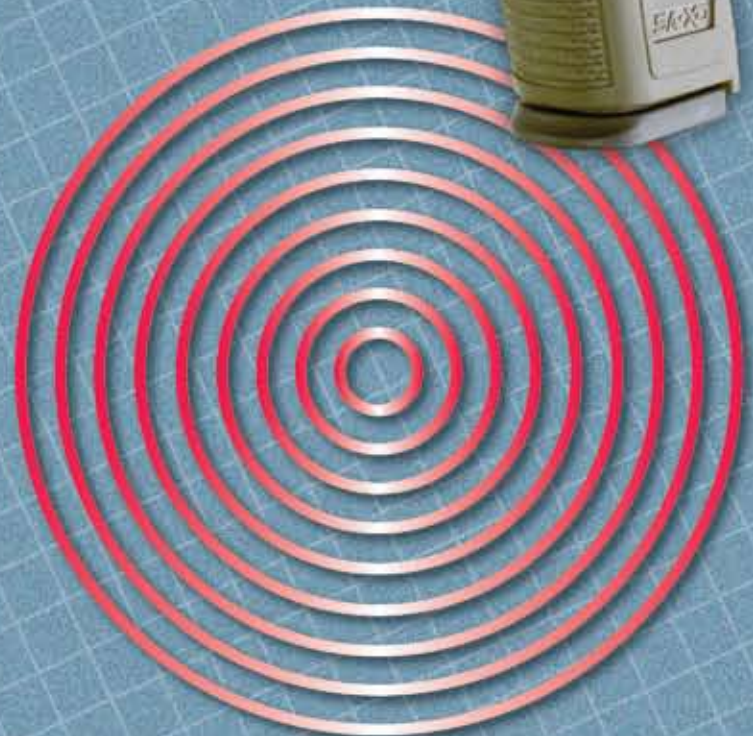

[www.laserlyte.com](http://www.laserlyte.com)

**Accuracy Defined**

# Sub Compact V2-Mini Rail Laser System

FSR-00V2-140

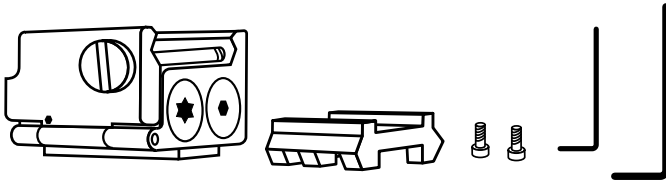

## Installation

- 1 **UNLOAD YOUR FIREARM!**
- 2 A. Loosen the clamp screw/cross bar.  
B. Align clamp screw/cross bar with cross cut on rail.  
C. Press the laser onto the rail.
- 3 Tighten the clamp screw/cross bar until snug.

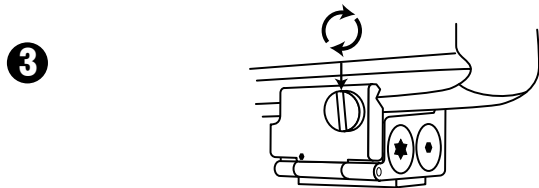
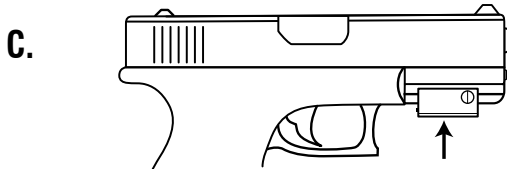
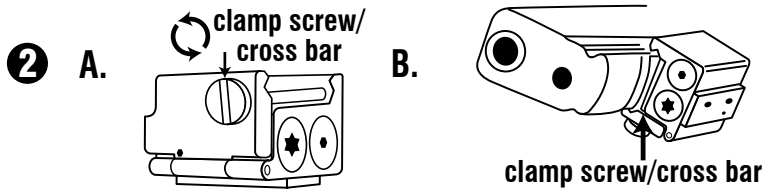

## Activation

- 1 Push orange button on the back -  
Once to turn ON and once to turn OFF

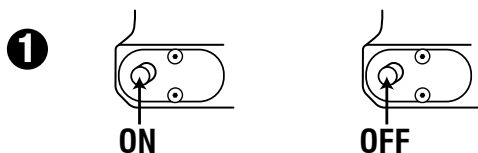

## Sight In

- 1 Locate the a) windage and b) elevation screw holes.
- 2 Use the provided .035 Allen wrench to adjust the laser in relation to the gun sights. End in a clockwise direction.
- 3 Make final adjustments at shooting range.

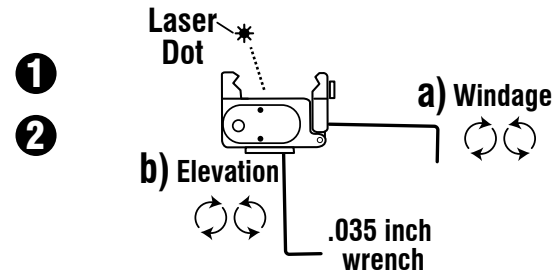

## Accessory Rail

- 1 Put the accessory rail on the bottom of the laser and align the three holes.
- 2 Insert the 2 provided screws and tighten down with the Allen wrench.

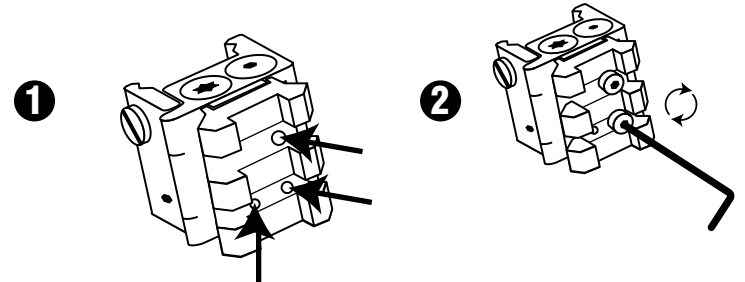

## Battery Replacement

- 1 Unscrew battery cap and remove batteries.
- 2 Insert 3-393 batteries with positive facing the battery cap and screw battery cap back in.

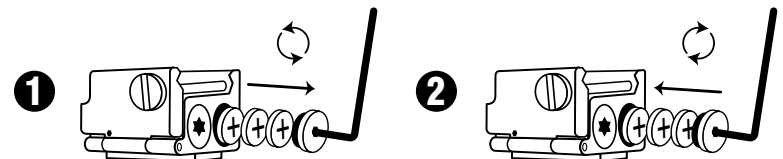

WARRANTY:  
One Year Limited  
Warranty.



**LASERLYTE**  
A Division of P&L Industries  
101 Airpark Road - Cottonwood, AZ 86326  
Phone 928-649-3201 - Fax 928-649-3970  
www.LaserLyte.com